

THE BRICKYARD
NORTHWEST 1/4 OF SECTION 35, TOWNSHIP 37 NORTH, RANGE WEST
PORTER COUNTY, TOWN OF PORTER, INDIANA
FOR
THE TOWN OF PORTER

PROPERTY DESCRIPTION DEED OF RECORD "95-02533"

PARCEL 1:

THE EAST 1/2 OF LOT 2 IN THE NORTHWEST 1/4 OF SECTION 35, TOWNSHIP 37 NORTH, RANGE 6 WEST OF THE SECOND PRINCIPAL MERIDIAN IN PORTER COUNTY, INDIANA, EXCEPTING THEREFROM THE RIGHT OF WAY OF THE NEW YORK CENTRAL RAILROAD COMPANY, ALSO EXCEPTING THE FOLLOWING: BEGINNING AT THE INTERSECTION OF THE INDIAN BOUNDARY LINE AND THE EAST LINE OF SAID NORTHWEST 1/4 OF SECTION 35; THENCE SOUTH ON THE EAST LINE OF SAID NORTHWEST 1/4 OF SECTION 35 A DISTANCE OF 992.18 FEET TO THE SOUTHEAST CORNER OF SAID NORTHWEST 1/4 OF SAID SECTION 35, A DISTANCE OF 160 FEET; THENCE NORTH AND PARALLEL WITH THE EAST LINE OF SAID NORTHWEST 1/4 OF SAID SECTION 35 A DISTANCE OF 995.7 FEET TO THE INDIAN BOUNDARY LINE; THENCE EAST ON THE INDIAN BOUNDARY LINE, A DISTANCE OF 160 FEET TO THE POINT OF BEGINNING AND ALSO EXCEPTING THE FOLLOWING: BEGINNING AT A POINT 1339.52 FEET, EASTERLY (AS MEASURED ALONG THE INDIAN BOUNDARY LINE, WHICH POINT OF BEGINNING IS THE INTERSECTION OF THE WEST LINE OF THE EAST 1/2 OF LOT 2 AND THE EXISTING SOUTH BOUNDARY, 36.06 FEET; THENCE SOUTH 46 DEGREES 43 MINUTES 10 SECONDS WEST 49.42 FEET TO THE WEST LINE OF THE EAST 1/2 OF LOT 2; THENCE NORTH ALONG SAID WEST LINE, 34.31 FEET TO THE PLACE OF BEGINNING.

PARCEL 2:

THAT PART OF THE WEST 1/2 OF THE NORTHWEST 1/4 OF SECTION 35, TOWNSHIP 37 NORTH, RANGE 6 WEST OF THE SECOND PRINCIPAL MERIDIAN IN PORTER COUNTY, INDIANA, LYING NORTH OF THE NORTH RIGHT OF WAY LINE OF THE NEW YORK CENTRAL RAILROAD AND SOUTHEASTERLY OF THE SOUTHEASTERLY RIGHT OF WAY OF INTERSTATE HIGHWAY 94.

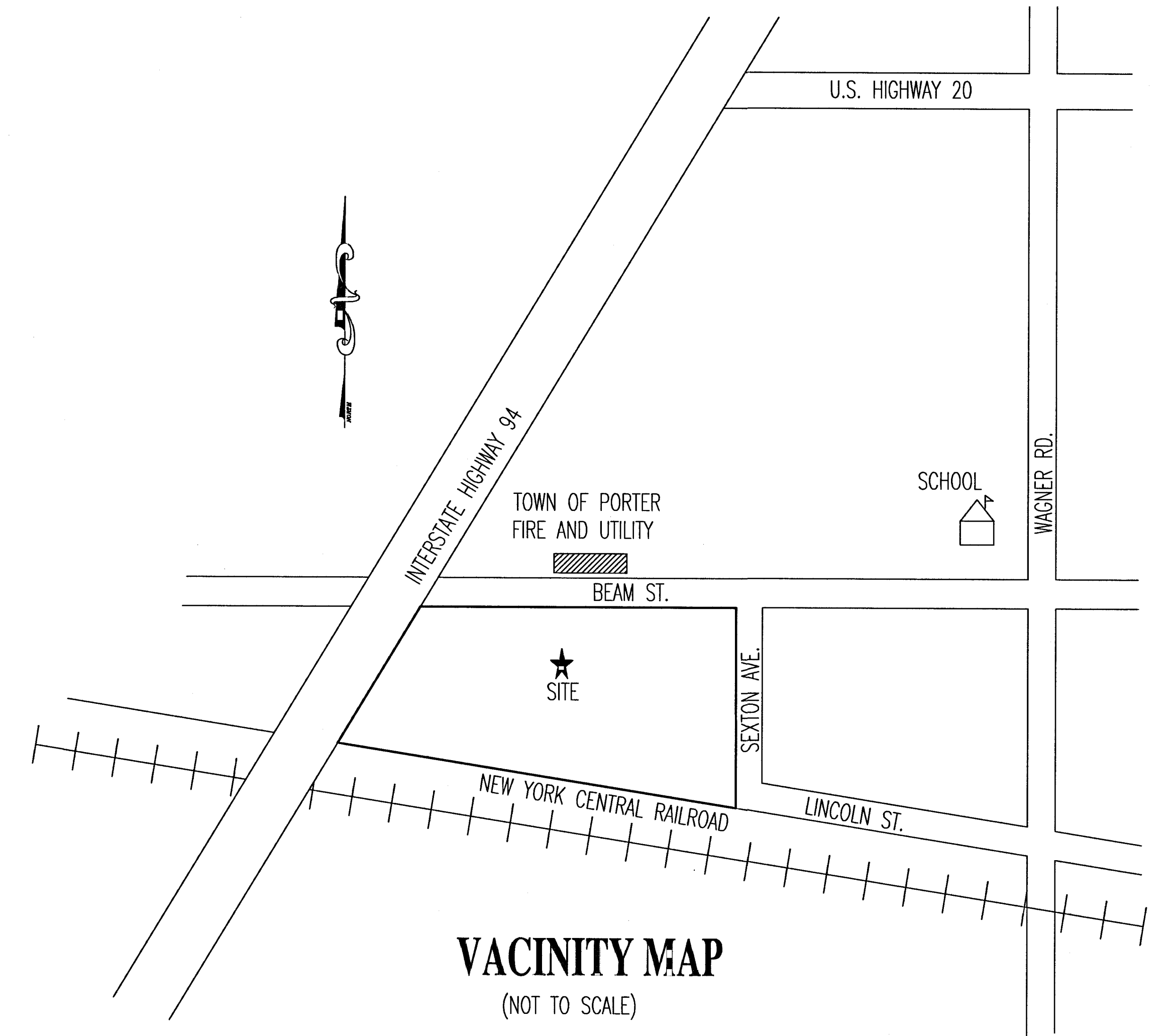

UTILITIES
 COMCAST-CABLE
 2000 OHIO ST
 LAPORTE, IN 46350

TOWN OF PORTER-SANITATION
 550 BEAM ST.
 PORTER, IN 46304

INDIANA AMERICAN WATER-WATER
 650 MADISON ST.
 GARY, IN 46402

VERIZON NORTHERN-PHONE
 2401 CHICAGO ST.
 VALPARAISO, IN 46383

N.I.P.S.C.O.-GAS & ELECTRIC
 801 E. 86TH AVE.
 MERRILLVILLE, IN 46410

CERTIFICATION
 THIS TO CERTIFY THE TOPOGRAPHIC SURVEY WAS PERFORMED
 WHOLLY BY ME AND UNDER MY DIRECTION,
 AND TO THE BEST OF MY KNOWLEDGE AND BELIEF
 THE SURVEY WAS EXECUTED ACCORDING TO THE
 STATE CODE

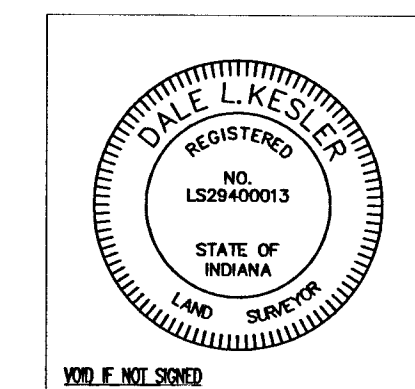

GLOBAL
 ENGINEERING & LAND SURVEYING, LLC.

email address: shem@global-landsurveying.com
 601 FRANKLIN SQ. STE. 407 MICHIGAN CITY, IN 46360
 PH. NO. (219)872-4444 FAX NO. (219)879-9920

CERTIFIED BY: *Dale Kesler*
 DATE: 1/22/10

THE BRICKYARD
NORTHWEST 1/4 OF SECTION 35, TOWNSHIP 37 NORTH, RANGE WEST
PORTER COUNTY, TOWN OF PORTER, INDIANA
FOR
THE TOWN OF PORTER



SURVEYOR REPORT
 THE PURPOSE OF THIS SURVEY IS TO PROVIDE A TOPOGRAPHICAL SURVEY WITH 1' CONTOURS FOR A PARCEL RECORDED AS DEED NO. "95-02533" IN THE OFFICE OF THE RECORDER IN PORTER COUNTY, INDIANA.
 THE BASES OF BEARING WAS BASED ON G.P.S.
 NOTE: THE DATUM FOR THIS SURVEY WAS BASED ON A NAVD 88 NGS MONUMENT ME1087 A BRONZE DISK STAMPED D 151 1946 IN CHESTERTON INDIANA LOCATED ON THE WEST SIDE OF THE HWY 57.1 FEET SOUTH OF THE SOUTH RAIL, 28.6 FEET WEST OF THE CENTER LINE OF THE HIGHWAY, AND 2.0 FEET WEST OF THE BACK OF CURB.

INFORMATION
 CLIENT: TOWN OF PORTER
 DATE OF THE RECORDED DEED: 2/08/1995.
 FILE NAME: IND9039
 DATE OF SURVEY: 12/16/09 TO 1/21/10
 DRAWN BY: SH
 PRINTED DATE: 01/22/10
 PROFESSIONAL LAND SURVEYOR: DALE KESLER
 ADDRESS: 601 FRANKLIN SQ. STE. 407 MICHIGAN CITY, IN 46360
 REGISTRATION NUMBER: LS29400013

LEGEND

F.I.R.	FOUND IRON ROD	SECTION CORNER
S.I.R.	SET IRON ROD	BENCH MARK
F.MAG	FOUND MAG NAIL	FOUND MONUMENT
(R)	RECORDED	WATER VALVE
E	EAST	GAS VALVE
W	WEST	FIRE HYDRANT
INV.	INVERT	FIBER OPTIC SIGN
ELEV.	ELEVATION	SANITARY MANHOLE
EP	EDGE OF PAVEMENT	DRAINAGE MANHOLE
OH	OVERHEAD	UTILITY POLE
UP	UTILITY POLE	OVERHEAD UTILITY LINES
EW	EDGE OF WATER	CHAIN LINK FENCE

GRAPHIC SCALE

(IN FEET)
 1 inch = 60 ft.

CERTIFICATION
 THIS TO CERTIFY THE TOPOGRAPHIC SURVEY WAS PERFORMED WHOLLY BY ME AND UNDER MY DIRECTION, AND TO THE BEST OF MY KNOWLEDGE AND BELIEF THE SURVEY WAS EXECUTED ACCORDING TO THE STATE CODE

GLOBAL
 ENGINEERING & LAND SURVEYING, LLC.
 email address: shem@global-landsurveying.com
 601 FRANKLIN SQ. STE. 407 MICHIGAN CITY, IN 46360
 PH. NO. (219)872-4444 FAX NO. (219)879-9920
 CERTIFIED BY: *Dale Kesler*
 DATE: 1/22/10